

✓ 8

John Anderson

27  
—  
1

and

Henry Fitzhugh and  
Others

N. C. R. R. and York Rd.  
near Phoenix Factory

---

In running start at the falls at a gum tree on the bank at the end of fence. then west to plum bush. then on till you reach the stone on the hill near the falls, then by the call, in the deed from Latrobe, south west. Just across the little branch, ~~in~~ the hollow to a blazed Hickory, then down the branch to the falls. about twenty yards below the mouth of the branch, then across the falls. to the south bank of Carroll's run. and then along the run to the centre of the rail road then along the centre of the railroad to the branch coming down from Alexs Scotts house then down the branch to the falls then to beginning at Gum trees.

You will need a boat to cross the falls. I can have mine. Col Webster at Mr Love's will go with you he knows the lines. Joshua Griffin has the lines between the land I sold him & that now sold. You had better see him.

H W Whittrick

Jesse Bennett M Sec of Scotts Branch

1195

H. M. Fitzhugh  
 To Dea. mbr  
 Levin Hopkins

382 + 247. 2<sup>ae</sup> 3<sup>ae</sup> 16 1/2 ps in

Deed dated the 17<sup>th</sup> July 1848. Recorded  
 in Liber A. W. B. No. 395. folio ~~442~~ 465.  
 All that lot piece or parcel of ground  
 situate lying and being in Ball County  
 and is contained within the metes bounds courses and  
 Distance following that is to say (Being part of a tract of  
 Land called "Alfred") Viz. Beginning at a point in the <sup>2<sup>nd</sup> 2<sup>nd</sup> 2<sup>nd</sup></sup> South  
 on South 11 E. line of the whole tract 30<sup>1</sup>/<sub>2</sub> ps. from the Beginning  
 of said line thence on the same line 12<sup>3</sup>/<sub>4</sub> ps thence S 79<sup>1</sup>/<sub>2</sub> W.  
 6<sup>2</sup>/<sub>10</sub> ps. N 13<sup>3</sup>/<sub>4</sub> W. 10<sup>5</sup>/<sub>10</sub> ps N 58<sup>1</sup>/<sub>2</sub> E. 7 ps. to the place of Beginning  
 containing and laid out for 73 sq ps of Land more or less.  
 together with the use of a way or Road of said Fitzhugh  
 where it passes along the N 58<sup>1</sup>/<sub>2</sub> E. 7 ps line of the above  
 Described Lot.

ae 2<sup>ae</sup>  
 3. 30.

Henry M. Fitzhugh } dated the 4<sup>th</sup> of February 1849  
 To Dea. } Recorded in Liber A. W. B. 419 folio ~~374~~ 414  
 Asa Stevenson } Beginning at a small ash tree stand-  
 ing on the East bank of the Great Sun-  
 powder falls and on the North Bank  
 of a small branch of said Falls and running thence  
 N 50 E. 16 ps to the Centre of the Ball's & Squehannanah  
 Rail Road thence along the Centre of said Rail Road  
 N 8° W. 54 ps. S 66 W. 7<sup>5</sup>/<sub>10</sub> to said falls. thence along said  
 falls the several courses to the place of Beginning  
 containing 3 acs and 34 sq ps. More or less.

H. M. Fitzhugh } dated the 19<sup>th</sup> Jan'y. 1849. Recorded in  
 To Dea. mbr } Liber A. W. B. No. 416. folio 338 & 3  
 Levin Hopkins } Beginning for the same on the East side of  
 the public turnpike Road at the corner  
 of Isaac Pries land and running and  
 bounding on said Pries land N 70 E 8.5 ps. S 11 E. 29.2.  
 S 58<sup>1</sup>/<sub>2</sub> W. 10.2 ps. N 7<sup>1</sup>/<sub>2</sub> W. 19.7 ps. N 9 W. 12 ps. to the Beg  
 containing 1 ac. 2 R. 37 ps. more or less.



410. 439.  
411. 485

416. 438 = to Levin Hopkins, Dec 1 1/2 ac. 5 pp

424. 92 = to Lashua Griffin, Dec 17 ac. 247

426. 320. L. S. Ridgely Seal

448. 265. 1<sup>st</sup> Price's Chance. of Alfred 110 ps. to N<sup>m</sup> Wheeler.

on April 2.

*[Faint, mostly illegible handwriting, likely bleed-through from the reverse side of the page.]*

*[Faint handwriting at the bottom of the page, possibly a signature or date.]*

$$\begin{array}{r} 24.5 \\ \hline 560 \\ 448 \\ 224 \\ \hline 27440 \end{array}$$

$$\begin{array}{r} 44.5 \\ \hline 3560 \end{array}$$

86  
 Deduct for falls: Length

$$\begin{array}{r} 14504 \\ 7814 \\ \hline 13233 \\ 3555.1 \end{array}$$

$$\begin{array}{r} 15998 \\ 9433.5 \\ 13233.28 \\ \hline 38664.78 \\ 37635 \\ \hline 102978 \end{array}$$

$$\begin{array}{r} 15998 \\ 9433.5 \\ 13233.28 \\ \hline 38664.78 \\ 38237.90 \end{array}$$

$$\begin{array}{r} 50 \\ \hline 400 \\ 500 \\ \hline 900 \end{array}$$

$$\begin{array}{r} 6 \\ 415 \\ \hline 415 \\ 415 \\ \hline 830 \end{array}$$

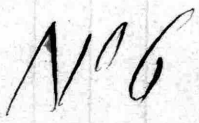

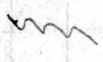

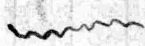

1.36:2.27

Courses Comprising Part of the Following Tracts of Land Situate  
 lying and being in Baltimore County viz "Part of Alfred" Part of "St  
 Thomas Adventure" Part of "Hell and Dale's" Part of "Hempden Mills"  
 Part of Taylor Purchase a lower of them that is contained within the  
 miles bounds courses and distances following that is to say Beginning  
 at a marked Ground Manding place by the side of the Em  
 pover Great falls. It being the beginning of the land conveyed by  
 John H. B. Catoh Trustee to said Henry M. Fitzhugh by deed bearing  
 date the 13<sup>th</sup> day of February 1848 and running thence S 68 3/4 W 149 8/10  
 to a post standing at the S E Corner of a lot of Ground now belonging to J. E. Lamb  
 formerly owned by a certain Hunt. then running S 39 1/2 degrees East 38 1/2 feet to  
 the North end of the said land leading from the York Turnpike Road to the Smelling  
 House place and now describing them running along the N E fence on said land  
 N 60 1/4 W 49 7/10 to the East side of the York Turnpike Road then running along  
 the East side of said York Turnpike Road N 4 1/2 E 1 7/10 then N 60 1/4 E 50 7/10  
 then S 39 1/2 E 3 7/10 to attain thence S 30 1/2 E 38 1/10 to attain marked I. thence  
 N 67 1/2 E 113 7/10 to attain marked C then S 9 3/4 E 15 2/10 to a marked Hickory  
 Sapling standing at the end of the first line of the land conveyed by Henry M.  
 Fitzhugh to a certain Samuel Griffin by deed bearing date the 5<sup>th</sup> April 1849 then  
 reversing the said first line of Samuel Griffin Part N 7 3/4 E 28 1/10 to the beginning of  
 said Griffin part then N 50 E 2 1/10 to the West Margin of the Hempden falls. then  
 running across the said falls N 34 1/2 E 5 1/10 to a small Walnut tree standing on the East  
 side of said falls and the South side of a Branch Run called Samolls Run. then  
 running along the South side of Samolls Run N 31 1/2 E 13 1/10 to the Centre of the Baltimore  
 and Tusquehanna Rail Road then running along the Centre of said Rail Road the  
 following courses and distances viz N 49 1/2 W 6 1/2 perches. N 39 1/4 W 100 feet. N 35 1/2 W 100 feet  
 N 35 1/2 W 100 feet N 31 1/4 W 100 feet N 22 1/4 W 100 feet N 15 W 100 feet N 13 1/2 W 100 feet N 6 1/4 W 100 feet  
 N 2 E 700 feet N 11 1/2 E 100 feet N 15 E 100 feet N 9 1/2 E 100 feet N 4 1/2 E 100 feet N 2 1/4 W 100 feet  
 N 9 W 100 feet N 15 1/2 W 100 feet N 12 W 100 feet N 25 1/2 W 100 feet N 35 1/2 W 100 feet N 40 W 100 feet  
 N 4 1/4 W 100 feet N 43 W 100 feet N 49 W 100 feet N 49 1/2 W 100 feet N 47 1/4 W 135 feet to the South  
 side of the Branch a run Run called and known as Sparks Run then running an  
 an boundary on the South side of said run S 30 W 5 1/10 then S 8 E 11 1/10 to the beginning  
 containing 141 acres 3 Moods and 30 perches of land more or  
 less Inclusion of the falls which contains 5<sup>00</sup> and 100 gallons. Being and being  
 a part of the Land conveyed by John H. B. Catoh Trustee to Henry M. Fitzhugh by deed  
 bearing date the 13<sup>th</sup> July 1848. The whole of the Land conveyed by John Hopkins to said Fitzhugh  
 by deed bearing date the 17<sup>th</sup> July 1848. Part of the Land conveyed by Laban Sparks and  
 Henry Small to said Fitzhugh by deed bearing date the 2<sup>nd</sup> June 1848. The whole of the  
 Ground conveyed by Abraham Miles and wife to said Fitzhugh by deed bearing date  
 the 10<sup>th</sup> July 1849. and Part of the Land conveyed by John Anderson and wife to said  
 Fitzhugh by deed bearing date the 19<sup>th</sup> January 1849. & ]

John L. Calhoun



$$\begin{array}{r}
 1 \\
 196 \\
 \underline{118.5} \\
 77.5 \\
 1568 \\
 \underline{196} \\
 196 \\
 \hline
 232260
 \end{array}$$

$$\begin{array}{r}
 2 \\
 196 \\
 \underline{39} \\
 1764 \\
 \underline{588} \\
 7644
 \end{array}$$

$$\begin{array}{r}
 3 \\
 133 \\
 \underline{49} \\
 1215 \\
 \underline{540} \\
 6615
 \end{array}$$

$$\begin{array}{r}
 4 \\
 45.5 \\
 \underline{10} \\
 4550
 \end{array}$$

$$\begin{array}{r}
 5 \\
 50.5 \\
 \underline{22.5} \\
 28 \\
 \underline{1010} \\
 113625
 \end{array}$$

$$\begin{array}{r}
 6 \\
 50.5 \\
 \underline{9.5} \\
 2325 \\
 \underline{4545} \\
 47975
 \end{array}$$

$$\begin{array}{r}
 7 \\
 157 \\
 \underline{113} \\
 44 \\
 \underline{57} \\
 741
 \end{array}$$

$$\begin{array}{r}
 8 \\
 133 \\
 \underline{26.5} \\
 665 \\
 \underline{798} \\
 266 \\
 35245
 \end{array}$$

$$\begin{array}{r}
 9 \\
 86.5 \\
 \underline{18} \\
 6920 \\
 \underline{865} \\
 15570
 \end{array}$$

$$\begin{array}{r}
 10 \\
 65 \\
 \underline{12} \\
 120 \\
 \underline{65} \\
 770
 \end{array}$$

$$\begin{array}{r}
 11 \\
 45 \\
 \underline{9} \\
 405
 \end{array}$$

$$\begin{array}{r}
 12 \\
 28 \\
 \underline{12.5} \\
 140 \\
 \underline{56} \\
 28 \\
 3500
 \end{array}$$

$$\begin{array}{r}
 13 \\
 14.5 \\
 \underline{3.5} \\
 725 \\
 \underline{435} \\
 3075
 \end{array}$$

$$\begin{array}{r}
 23226 \\
 7644 \\
 \underline{6615} \\
 37485
 \end{array}$$

$$\begin{array}{r}
 455 \\
 1136.25 \\
 479.75 \\
 741 \\
 3524.50 \\
 1557.00 \\
 770.00 \\
 405.00 \\
 350.00 \\
 50.75 \\
 \hline
 9469.25 \\
 37485 \\
 \hline
 66954.24 \\
 160 \left) \begin{array}{r} 23477 \\ 160 \\ \hline 747 \\ 640 \\ \hline 1077 \\ 966 \\ \hline 117 \end{array} \right. \left( \begin{array}{r} 146.50 \\ 5.00 \\ \hline 141.50 \end{array} \right)
 \end{array}$$



75.13 46.11 1 2 3 4 5

179.8 172. 196 30 35.5

73.6 149.5 74 14 177.5

10788 860 784 120

12586 628 1372 30

13233.28 7814 14504 420

13233.28 420 13233.28

420 17.7 5.0

4696. 25

1020 50

2744

356

44965.03

22482.76

160

648

440

82

140. 2.00

13241 0.22

4.2.00

136.2.22

86 1 2 3 4 5

112 24.5 5.60 448 224

27440

44.5 8 3560.

14504 7814 13233 35551

15998 9433.5 13233.28 38664.78 37635 102978

15998 9433.5 12806.4 38237.90

50 400 50 90.0

41.5 11 415 415 4565

1 2 3 4 5 6

179.8 210.5 210.5 30 36 146

73.6 192.5 76 14 35 47

1078.8 49 12630 120 180 146

5394 17325 14735 20 584

12586 7700 159980 420 5986

13233.28 9432.5

174 73.6 1044 522 1218 128064

74 29 846 188 2726 906.15 1819.85

72.5 125 357.5 1450 725 906.15

13233.28 94.32.50 15998.00 420 180 456 5986 1819 47097 23548 1470.28 160 160 390 1420.18 148. 2.00 2.00 149. 0.00 1362 deduct pupae 5. 0. 10 1280 82 143. 3. 20

9th hole deduction

136.5 540.0

196 50 9800

196 73 588 1372 14308 9800 24108 13233.28 37341.28

196 74.5 980 784 137.2 146020 9800 13233.28 37625.28 1540 38194.28

1148 1130 125

Extract of J<sup>no</sup> Anderson  
 Property near Phoenix  
 Factory on N<sup>th</sup> Central R.R.

108.21	1834
53.3	1835
160.7	122.
	1854
	1858

N<sup>o</sup> 1 129x

83 3/4	26 3/4
1 1/2	13 1/4
<u>85 1/4</u>	42 1/2
90	
24 1/4	
65 3/4	

18

Chas Cooper to  
to  
Ens Anderson

Release  
Deed dated May 30<sup>th</sup> 1828,  
Recorded N 4, N 193 p 357/4  
Deed dated Feb 10<sup>th</sup> 1829  
1828, Recorded W 1, N 193 p 358/4.

P<sup>r</sup> of "Gumpwader Mills", "Hills & Dales" & "Taylor's Purchase". Beginning for the same at a stone set up in the ground & marked with the letter MC N<sup>o</sup> 1, 1787 and  
=ing at the end of the N 87 E 72 ps line of "Hills & Dales" and  
=inning thence N 21, 8' E 105 7/8 ps to a stone, N 80 W 21 1/2 ps to  
a stone, N 37 W 14 ps to a stone, N 68, 45' W 45 5/8 ps to a stone, N 3 1/4  
E 10 3/8 ps to a bounded red oak, N 47 1/4 W 24 ps + 2/10 of a perch  
=sects the S 75 W 42 1/4 ps line of a part of a tract of land  
called Carlos Purchase, thence running with said line  
S 75 W 15 1/4 ps to a bounded black oak, South 82 W 80  
ps to a bunch of Maples near the Falls, thence running  
down & binding on the East side of the falls the 18 fol-  
=owing courses S 25 E 6 ps, S 7 E 8 ps, S 14 W 6 ps, S 23 W 10 ps,  
S 11 W 10 1/8 ps to a marked white oak, S 11 1/2 W 7 ps, S 6 W  
11 ps, S 3 3/4 W 15 3/4 ps, S 18 E 9 1/4 ps, S 42 1/2 E 10 ps, S 63 1/4 E  
12 ps, S 38 1/2 E 13 ps, S 69 E 27 ps, S 57 1/2 E 12 ps, S 37 E 10 ps,  
S 27 1/2 E 11 ps, S 8 1/4 E 8 ps, S 24 1/2 E 53 3/8 ps, thence N 83 1/4 E  
12 ps until it intersects a line run from the beginning  
stone mentioned & marked as aforesaid S 47 W 48 3/4 ps  
and at the end of said line, thence running with &  
= bounding on said line reversely N 47 E 48 3/4 ps to the  
first place of beginning, Contains 139 acres of land more or  
less.

Jas Jessup & wife to Ens Anderson  
Deed dated June 15<sup>th</sup> 1835, 5K N 249 folio 3238C  
P<sup>r</sup> of Carlos Purchase & P<sup>r</sup> of Hills & Dales, Beginning  
for the same at a stone standing at the end of the 1<sup>st</sup>  
line of a deed heretofore given by Chas Cooper to  
Ens Anderson and running thence N 21 1/2 E 55 1/2 ps to a stone  
N 22 1/2 W 49 ps, S 45 1/2 W 24 ps, N 67 1/2 W 30 1/2 ps, S 63 1/2 W 17 ps, S 75 1/2 W  
26 3/4 ps until it intersects the end of the N 14 E 17 3/4 ps line of the



aforsaid deed, thence running with the boundary on said deed heads by the 6 following courses, S 14 W 17 3/4 ps to a marked Walnut tree, S 47 1/4 E 24 3/10 ps to a marked black oak, S 3 1/4 W 10 8/10 ps to a stone, S 68 3/4 E 45 3/10 ps S 37 E 14 ps, S 80 E 21 1/10 ps to the beginning, Containing 40 ~~acres~~ more or less.

John Anderson & wife } Deed dated Jan 7 19<sup>th</sup> 1849,  
to } Recorded B.W.B. W 410 f 5 337c,  
H. M. Fitzhugh } 7.

Being Part of land conveyed by Cooper & others to Anderson. Beginning for the same at the angle now formed by the stream usually called Carrol's Run which empties into the Great Gunpowder Falls, on the East Bank of said Falls & the South Bank of said Falls & running thence along the South eastern Bank of said Run the 2 following courses N 24 E 26 ps, thence N 66 1/2 E 34 5/10 ps to a white Walnut Tree thence crossing said Run N 1/2 W 64 1/10 ps to where it intersects the land of Abraham Miles at a stone now standing in the S 8 3/4 W line of the whole tract thence along said last line 52 ps to the East Bank of the Great Gunpowder Falls near a Maple tree thence along the said Falls S 3 E 12 ps, thence S 52 W 28 3/10 ps, thence S 3 W 40 ps, thence S 52 E 25 ps to the beginning, Containing 28 Ac + 2 ps more or less. Together with all the right usually called the water right (being the right to use for milling purposes manufacturing or other purposes the whole stream and some of the said run called Carrol's Run by Dam or Dams Race or Races) of them the said John Anderson his wife or said run with the right to the said Fitzhugh to erect a dam or dams and dig a race or races for the more effectual enjoyment of the said water right in any place where it would now be lawful for the said Anderson to erect or dig &c.



$$\begin{array}{r} 139 \frac{1}{4} \\ 40 \frac{1}{4} \\ \hline 179 \frac{1}{4} \\ 28 \frac{1}{2} \\ \hline 150 \frac{3}{4} \end{array}$$

$$\begin{array}{r} 40 \frac{1}{4} \\ 110 \frac{1}{2} \\ \hline 150 \frac{3}{4} \end{array}$$

No 4

H. M. Fitzhugh } Dated the 2<sup>nd</sup> of April 1849. Recorded in  
Do Deed } A.M.B. N<sup>o</sup>. 454. folio 928. Beginning for the  
Joshua Griffin } same at a point on the West bank of the  
Great Sunpoder falls. which is North 73 E.  
28 ps. from a mark on Hickory in the line of Joel Mathews  
land on the south side of a small stream being 13  $\frac{3}{10}$  ps.  $\frac{2}{10}$  ps from  
S 9  $\frac{3}{4}$  E. of a corner stone of the land of said Fitzhugh Marked  
E. thence reversing said line to said Hickory S 73 W. 28 ps. thence  
by said Mathews land S 9  $\frac{3}{4}$  E. 59  $\frac{8}{10}$  ps. to a stone thence  
N 66  $\frac{1}{4}$  E. 71  $\frac{5}{10}$  ps. to the West Bank of said falls thence up  
the Bank of said falls the several courses. to the B.C.'s  
Containing 17 ac. 24 ps. more or less. Being pt of a  
tract called Alfred.

H. M. Fitzhugh } Dated the 17<sup>th</sup> of Feby 1848. Recorded in  
Do Deed } Liber A.M.B. N<sup>o</sup>. 448 folio 263. &  
Wm. Wheeler } all that tract of parcel of land by in  
in Ball's County. now called Sweet Home. "being part  
of two tracts called Prices chance & Alfred" contained  
within the metes bounds courses and Distances following  
that is to say B.C.'s for the same at an old oak stump  
and running S 66  $\frac{1}{4}$  W. 5  $\frac{5}{10}$  ps. S 12  $\frac{3}{4}$  E. 4  $\frac{1}{10}$  ps. S 73  $\frac{1}{4}$  W.  
5  $\frac{7}{10}$  S 11 W. 8  $\frac{2}{10}$  ps. N 73 E. 5  $\frac{4}{10}$  ps. N 12  $\frac{3}{4}$  W. 9 ps. N 78 E 6 ps  
S 10 E. 12 ps. and 8 tenths. to the B.C.'s Containing con 110 ac  
ps of land more or less.

Fitzhugh's Land  
Sold to Esq.  
John Caldwell  
on York Turnpike Road,

NO 3



Handwritten notes in a triangular diagram:

- Top vertex: 3
- Left side: 42939
- Right side: 16323
- Bottom side: 27412
- Internal diagonal (top-left to bottom-right): 2484
- Internal diagonal (top-right to bottom-left): 916

Wednesday Feb. 9<sup>th</sup> 1853 MARR

Began at the summit by the falls standing by at a place no longer with the top broken off. Then as the beginning of the land conveyed by Catherine Fitzhugh and running thence

1 S 70 W 179 8/10 ps thence S 20 E 3 1/10 to the corner post at S E corner of the lot formerly owned by Hunt and now owned by J. E. Lamb then run from said post

2 S 39 1/2 E 77 1/2 ps to a stone (at 38 1/2 ps North face of same leading to the road

3 S 30 1/2 E 58 5/10 ps to a stone mark

4 N 67 1/2 E 113 8/10 ps to a stone mark

5 S 79 3/4 E 15 1/10 ps to a marked tree sapling in the end of the 1<sup>st</sup> line of the land surveyed by Fitzhugh to Joshua Griffin in the 2<sup>nd</sup> April 1849 then running said line

6 N 73 E 25 ps to the beginning of said line then

7 N 57 E 2 ps to the West side of the Improver Great falls.

Then sighted a White Walnut tree standing on the East side of said falls and South side of barrel, run N 54 1/2 E then run up the falls N 48 1/2 W 6 ps falls 3 ps in a

the White Walnut tree bears S 83 1/2 E the face of the East side of the falls bears N 40 W true along the West side of the falls S 58 1/4 W 2 1/10 ps the N side of the falls bears N 40 W

Then went across the falls to the White Walnut tree and run

N 21 1/2 E 13 6/10 ps to the center of rail road. this line reverses

118 Gothenum along the center  
of Rail Road

- 1 N 49 W  $\frac{1}{2}$  ft. 938 corners S 42  $\frac{1}{2}$  E
  - 2 N 39  $\frac{1}{2}$  W 100 ft 939 corners S 42 E
  - 3 N 35  $\frac{1}{2}$  W 100 ft 940 " S 37  $\frac{3}{4}$  E
  - 4 N 31  $\frac{1}{2}$  W 100 ft 941 " S 29 E
  - 5 N 22  $\frac{1}{2}$  W 100 ft 942 " S 20  $\frac{1}{4}$  E
  - 6 N 15 W 100 ft 943 " S 20  $\frac{1}{4}$  E
  - 7 N 13  $\frac{1}{2}$  W 100 ft 944 " S 12  $\frac{1}{2}$  E
  - 8 N 6  $\frac{1}{4}$  W 100 ft 945 " S 7  $\frac{1}{2}$  E
- falls 2 ft on my left
- 9 N 2 E 100 ft 946 " S 6 W
- falls 2 ft on my left
- 10 N 11  $\frac{1}{2}$  E 100 ft 947 " S 12  $\frac{1}{2}$  W
- falls 2 ft on my left
- 11 N 15 E 100 ft 948 " S 13  $\frac{1}{2}$  W
- falls 2 ft on my left
- 12 N 9  $\frac{1}{2}$  E 100 ft 949 " S 10  $\frac{1}{2}$  W
- falls 2 ft on my left
- 13 N 14  $\frac{1}{2}$  E 100 ft 950 " S 5  $\frac{3}{4}$  W
- falls 2 ft on my left
- 14 N 2  $\frac{3}{4}$  W 100 ft 951 " S 11  $\frac{1}{4}$  E
- falls 2 ft on my left
- 15 N 19 W 100 ft 952 " S 9  $\frac{1}{4}$  E
- falls 4 ft on my left
- 16 N 15  $\frac{1}{2}$  W 100 ft 953 " S 5 E
- falls 6 ft on my left
- 17 N 12 W 100 ft 954 " S 19 E
- falls 8 ft on my left
- 18 N 25  $\frac{1}{2}$  W 100 ft 955 " S 30  $\frac{1}{2}$  E
- falls 8 ft on my left
- 19 N 35  $\frac{1}{2}$  W 100 ft 956 " S 36 E
- falls 8 ft on my left
- 20 N 40 W 100 ft 957 " S 36  $\frac{1}{4}$  E
- falls 8 ft on my left
- 21 N 41  $\frac{1}{4}$  W 100 ft 958 " S 39 E
- falls 8 ft on my left
- 22 N 43 W 100 ft 959 " S 46  $\frac{1}{4}$  E
- falls say 9 ft on my left
- 23 N 49 W 100 ft 960 " S 46  $\frac{3}{4}$  E
- falls say 9 ft on my left
- 24 N 49  $\frac{1}{2}$  W 100 ft 961 " S 46 E
- falls say 8 ft on my left, Begin

my gunned bears S 51  $\frac{1}{2}$  W  
25 N 47  $\frac{1}{4}$  W 155 feet along 962 and 963  
line river S 51  $\frac{1}{2}$  E Gunnebury  
by W, then run S 50 W  $\frac{1}{2}$  ft to the  
center of the W side of the culvert on  
run then S 50 W  $\frac{3}{4}$  ft  
then about S & E 2 ft to the falls then  
course strikes the Gunnebury then  
run from end of 2 ft line S 33  $\frac{1}{4}$  W  $\frac{1}{2}$  ft  
to the East side of the falls from the  
place beginning Gunnebury  
S 40  $\frac{1}{2}$  W.

Then went to end of 38  $\frac{1}{2}$  ft on  
the S 39  $\frac{1}{2}$  E 77  $\frac{1}{2}$  ft line and made  
the center point side of the road  
at end S 60  $\frac{1}{4}$  W 51  $\frac{1}{4}$  ft to the corner  
of the York Turnpike Road at  
the Top Gate, then along the center  
of said Turnpike Road S 4  $\frac{1}{2}$  E  
18 ft then N 60  $\frac{1}{4}$  E 52  $\frac{1}{4}$  ft to the  
S 39  $\frac{1}{2}$  E line a fence at 31  $\frac{1}{4}$  ft  
Gate Lane a road at East end  
28 ft wide

John H. B. Labore Trustee Deed  
Henry M. Fitzhugh <sup>date</sup> 31<sup>st</sup> July 1848

1848 and recorded in Liber N. 13

N<sup>o</sup> 392 folio 445 &c. All the  
of resaid Tracts of Land and pre-  
mises situate lying and being  
in Baltimore County, and contain-  
ed within the metes and bounds  
courses and distances following

Beginning for the same at a  
Cypress Standing on the West  
side of the Great Hampden Falls

thence 1 S 69<sup>W</sup> 179 p to a Plum  
Bush (at the root of which is now  
planted a stone) Standing at the  
S E Corner of Hunts Lot thence

2 N 37<sup>3</sup>/<sub>4</sub> E 76<sup>7</sup>/<sub>10</sub> p to a stone  
thence 3 S 30<sup>2</sup>/<sub>2</sub> E 58<sup>2</sup>/<sub>2</sub> p to a stone  
marked **L** thence

4 N 67<sup>2</sup>/<sub>2</sub> E 113<sup>1</sup>/<sub>4</sub> p to a stone  
marked **C** thence

5 S 9<sup>3</sup>/<sub>4</sub> E 75 p to a stone  
thence 6 N 66<sup>1</sup>/<sub>4</sub> E 71<sup>1</sup>/<sub>2</sub> p to the  
West Bank of the Great Hampden  
falls



falls. thence up the said falls and  
bounding thereon

- 7 N 37 W 6 <sup>7</sup>/<sub>10</sub> p thence
- 8 N 55<sup>2</sup> W 22 <sup>7</sup>/<sub>10</sub> p "
- 9 N 60 W 22 <sup>7</sup>/<sub>10</sub> p "
- 10 N 46 W 40 p "
- 11 N 5 E 24 p "
- 12 N 10 E 48 p "
- 13 N 23 W 13 p "
- 14 N 32<sup>2</sup> W 17 <sup>2</sup>/<sub>10</sub> p "
- 15 N 30 W 26 p to the

place of beginning containing  
a Supposed to contain 149. 1<sup>13</sup>  
of land and more. And being  
Parts of 3 Tracts of land called  
"Alfred" "St Thomas Adventure"  
and "Hills and Dale."

Also part of "Alfred" containing  
within the meter bounds courses  
and distances following Beginni-  
ng at a stone standing on the East  
side of the York Road near Israel  
Price stable and running thence

- 1 N 74 E 7 <sup>3</sup>/<sub>4</sub> p to the corner of  
Harris Lot thence
- 2 N E 54 <sup>2</sup>/<sub>10</sub> p to the corner of  
Price

Lot thence  
3 N 63 W 5 <sup>2</sup>/<sub>10</sub> p to Joseph Math-  
ingtons Lot thence

- 4 N 13 <sup>3</sup>/<sub>4</sub> W 35 <sup>2</sup>/<sub>10</sub> p to the place  
of Beginning supposed to con-  
tain a  
2. 1. 16 <sup>2</sup>/<sub>10</sub> p off and more

unless this last part is no part of  
the said sold by Mr Fitzhugh to Mr  
Caldwell.

Sevin Hopkins Deed  
Henry M Fitzhugh 2 dated  
3<sup>rd</sup> day of  
July 1848 and recorded in the  
A. N. 13 N. 392 folio 447. &c

Whereas a right of way has long been en-  
joyed by the land of which the said Henry  
M Fitzhugh hath lately become the purcha-  
ser across the land of the said Sevin Hop-  
kins in virtue of an agreement between  
the said Sevin and the former proprietors  
of the land of the said Henry that  
compensation should be made for the  
said right of way in such quantity  
off and as would equal that occu-  
pied by such way from and of owned  
by said proprietors, and now by said  
Henry lying immediately between  
the land of said Sevin and a narrow  
strip of land of Joseph Price lying  
on the East side of the York Turnpike  
which said agreement was never  
fulfilled and it being the intention



Land and premises situate in  
Baltimore County and state of Md  
said being all the land owned by the  
said Sparks lying between the  
Center of the Baltimore and Annapolis  
and the Great Falls  
Road as at present  
said road and the Great Falls  
where it now runs.

land out for and containing 12 acres  
and 37 square perches of land more  
or less. regarding to the said land  
Sparks his heirs and assigns the  
right of way as it exists at pre-  
sent across the said land

Abraham Miles Trust 2 Dec  
do do do  
Henry M. Fitzhugh 3 10 July  
1848  
A. M. B. No 409 folio 46 &

All that lot piece and parcel of ground  
situate lying and being in the county  
of said Baltimore. Being all the land owned  
by the said Miles between the Center of  
Baltimore and the Annapolis  
Road and the Great Falls  
falls supposed to contain about  
one acre of ground, together with  
sufficient space on the opposite  
or East side of said Road where  
the

ground will amount of it to be  
conveyed to a firm of said way or  
on the said side of said Miles. -  
together with the free use and en-  
joyment to him the said Henry M.  
Fitzhugh his heirs and assigns  
of all the rights possessed in and  
to the said land by the said  
Road by him the said Miles  
in common with the said Miles  
the said Miles hereby acknowledging  
that all the Map and map laid  
down and a Certificate has been  
made for and belongs to said Henry

John Anderson Imp 2 Dec  
Henry M. Fitzhugh 3 do do  
January 1849 A. M. B. No 400 folio  
333 & Part of the Legal Tracts called  
"Empowder Mills" "Taylors Paddock"  
and "Hills and Dales" and contained  
within the metes and bounds  
and distances following viz.  
Beginning for the same at the  
angle now formed by the stream usually  
called "Snolls Run" where it  
crosses into the Great Empowder falls  
on the East Bank of said falls and  
the South Bank of said Run and  
running thence along the South  
Eastern

Eastern Bank of said River the  
following courses viz

- 1 N 24° E 26 p<sup>ts</sup> then a
- 2 N 66° E 34 p<sup>ts</sup> to a white Walnut  
Tree then a crossing said river
- 3 N 12° W 64 9/10 p<sup>ts</sup> to where it enters  
cuts the land of the ham Mills  
at about now standing in the S 83° W  
line of the whole tract then a lay  
said last line 52 p<sup>ts</sup> to the East Bank  
of the Great Timpson falls near  
a maple tree then a lay the same  
falls S 13° W 12 p<sup>ts</sup> then a
- 6 S 12° W 28 8/10 p<sup>ts</sup> "
- 7 S 30° W 40 p<sup>ts</sup> "
- 8 S 52° E 25 p<sup>ts</sup> to the beginning

Said act for and containing <sup>to n</sup> 28.0.02  
of said Manassas (to wit he will  
all the rights usually called the  
Water rights being the right to run  
for Milling Manufacturing or other  
purposes the whole stream and power  
of the said run called farrow run  
by dam Race a Races.) of them the  
said John Anderson & wife in the  
said Run with the right of the  
said T. H. Wright to erect a dam or  
Dams and dig a race or races for  
the more effectual enjoyment of  
the said Water right, in any place  
or

places, where it would <sup>be</sup> lawful  
for the said Anderson to dig <sup>or</sup> <sup>to</sup> <sup>dig</sup> <sup>from</sup> <sup>the</sup> <sup>land</sup> <sup>of</sup> <sup>the</sup> <sup>said</sup> <sup>T. H. Wright</sup> shall pay to  
the said Anderson at the rate of  
\$50 per acre for all land of the said  
Anderson that may be covered by the  
Water (see further Carrant)

Appt of this Act described only  
conveyed to the said

15  
 Wednesday morning July 9<sup>th</sup>  
 1853 Began at the junction  
 the by the falls down  
 down by a maple now  
 decaying with the top  
 broken off and air  
 S 70 W 179 ft then S 20 E  
 3<sup>10</sup> to be the depth at the  
 S E. corner of the lot  
 then came from the same to  
 the corner of the lot S  
 68<sup>1</sup>/<sub>4</sub> E 139<sup>1</sup>/<sub>4</sub> ft 77<sup>1</sup>/<sub>2</sub> ft  
 at the corner of the lot of Lane  
 S 30 E 58<sup>1</sup>/<sub>2</sub> ft to the S  
 N 67<sup>1</sup>/<sub>2</sub> E 110<sup>1</sup>/<sub>2</sub> ft to the  
 marked corner  
 S 9<sup>1</sup>/<sub>4</sub> E 15<sup>1</sup>/<sub>2</sub> ft to a  
 marked stake of the land  
 sold by J. H. Lough to the  
 the with the surface line  
 the N 73 E 28 ft then  
 the N 73 E 2 ft to the  
 side of the fall a narrow  
 narrow side of woods  
 on and East side of the falls  
 by N 54<sup>1</sup>/<sub>2</sub> E then at the  
 falls N 48<sup>1</sup>/<sub>2</sub> W 6 ft falls  
 3 ft wide the Walnut being

183<sup>1</sup>/<sub>2</sub> E then along the falls  
 S 8<sup>1</sup>/<sub>4</sub> W 2<sup>1</sup>/<sub>2</sub> ft from  
 the corner to the head of the  
 falls by N 40 W. then  
 went to the Walnut tree  
 on E side of the falls and  
 S side of the same on an  
 on N 2<sup>1</sup>/<sub>2</sub> E 13<sup>1</sup>/<sub>2</sub> ft to the foot  
 of the road then line  
 across S 18 E then along the  
 corner of the road N 49<sup>1</sup>/<sub>2</sub> W  
 6<sup>1</sup>/<sub>2</sub> ft then line runs S 42<sup>1</sup>/<sub>2</sub> E  
 N 39<sup>1</sup>/<sub>4</sub> W 100 ft R S 37<sup>1</sup>/<sub>4</sub> E  
 N 35<sup>1</sup>/<sub>2</sub> W 100 ft R S 37<sup>1</sup>/<sub>4</sub> E  
 N 31<sup>1</sup>/<sub>4</sub> W 100 ft R S 29<sup>1</sup>/<sub>2</sub> E  
 N 22<sup>1</sup>/<sub>4</sub> W 100 ft R S 20<sup>1</sup>/<sub>4</sub> E  
 N 15<sup>1</sup>/<sub>2</sub> W 100 ft R S 20<sup>1</sup>/<sub>4</sub> E  
 N 13<sup>1</sup>/<sub>2</sub> W 100 ft R S 12<sup>1</sup>/<sub>2</sub> E  
 N 6<sup>1</sup>/<sub>4</sub> W 100 ft R S 9<sup>1</sup>/<sub>2</sub> E  
 falls 2 ft on my left  
 N 2 E 100 ft R S 4 W  
 falls 2 ft on my left  
 N 11<sup>1</sup>/<sub>2</sub> E 100 ft R S 12<sup>1</sup>/<sub>2</sub> W  
 falls 2 ft on left  
 N 15 E 100 ft R S 13<sup>1</sup>/<sub>2</sub> W  
 falls 2 ft on left  
 N 9<sup>1</sup>/<sub>2</sub> E 100 ft R S 10<sup>1</sup>/<sub>2</sub> W  
 falls 2 ft on left  
 N 4<sup>1</sup>/<sub>2</sub> E 100 ft R S 5<sup>1</sup>/<sub>4</sub> W  
 falls 2 ft on left



N 2 3/4 W 100 ft R S 11 1/4 E  
fueled 2 p left

N 19 W 100 ft R S 9 1/4 E  
fueled 4 p left

N 15 1/2 W 100 ft R S 5 E  
fueled 6 p left

N 12 W 100 ft R S 19 E  
fueled all 8 p left

N 25 1/2 W 100 ft R S 30 1/2 E  
fueled all 8 p left

N 35 1/2 W 100 ft R S 36 E  
fueled all 8 p left

N 40 W 100 ft R S 36 1/4 E  
fueled all 8 p left

N 41 1/4 W 100 ft R S 39 E  
fueled all 8 p left

N 43 W 100 ft R S 46 1/4 E  
fueled say 9 p left

N 49 W 100 ft R S 46 3/4 E  
fueled say 9 p left

N 49 1/2 W 100 ft R S 46 E  
fueled all 8 p left

leggy gum bars S 51 1/2 W  
N 47 1/4 W 155 ft R S 51 1/2 E

gum bars S 7 W then S 50

W 2 p to W about 1/2 mi

on N 1/2 mi S 50 W 3 1/4

S 8 E 2 p to fueler same as

well State Gum bar  
then down to fueler S 33 1/4 E

9 p to gum bars  
S 40 1/2 W then out to  
of 38 1/2 p mile S 39 1/2 E

and on along the S side of  
the road S 60 1/4 W 51 1/2 p

to gate at 21 3/4 p gate to  
Center of gate to fueler road

then along the S side of  
fueler road S 4 1/2 E 1 1/2

N 60 1/2 E 52 1/4 p (at 30 top  
gate) to the S 39 1/2 E

road between fence S 28 1/2 E  
mile



N<sup>o</sup> 2

40.2  
 38.5  
 1.8  
 40.3  
 77.5  
 40.3  
 37.2

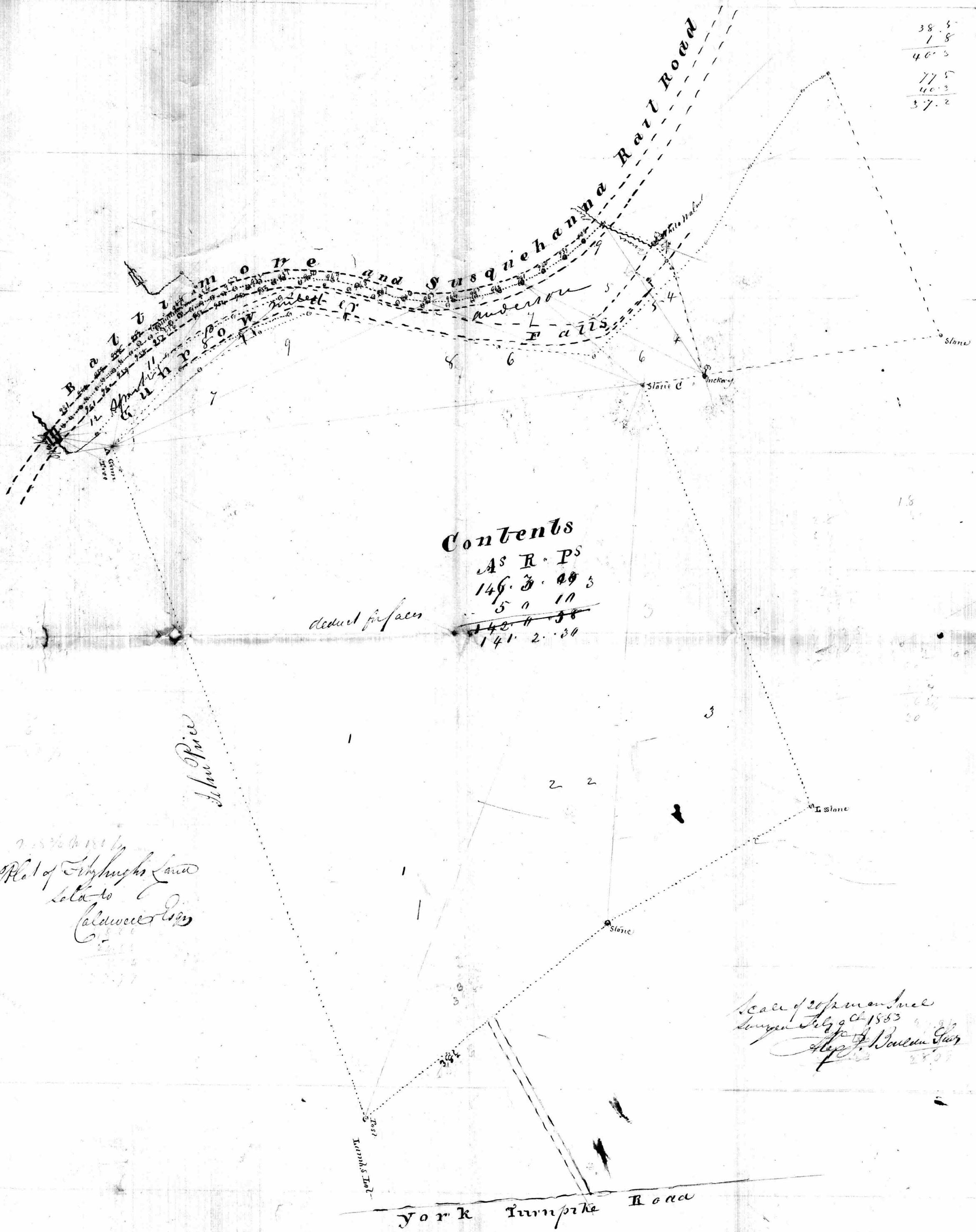

**Contents**

AS	R.	PS
146	3	48 3
5	0	10
<hr/>		
142	0	58
141	2	30

deduct for acres

Plot of Cityhugh's Land  
 sold to  
 Caldwell Esq.

Scale of 20 paces to an inch  
 Survey July 9th 1853  
 Wm. B. Caldwell Esq.

York Turnpike Road